

Chronicle

1,996 sq. ft.

Capacity:

Theater Style - 122 seats

Training Style A* - 80 seats

Training Style B* - 60 seats

Boardroom Style* - 54 seats

*Please note an additional charge applies to set ups other than normal classroom style configuration

Maximum Occupancy: 133

Natural light option or capability to black-out the room for privacy.

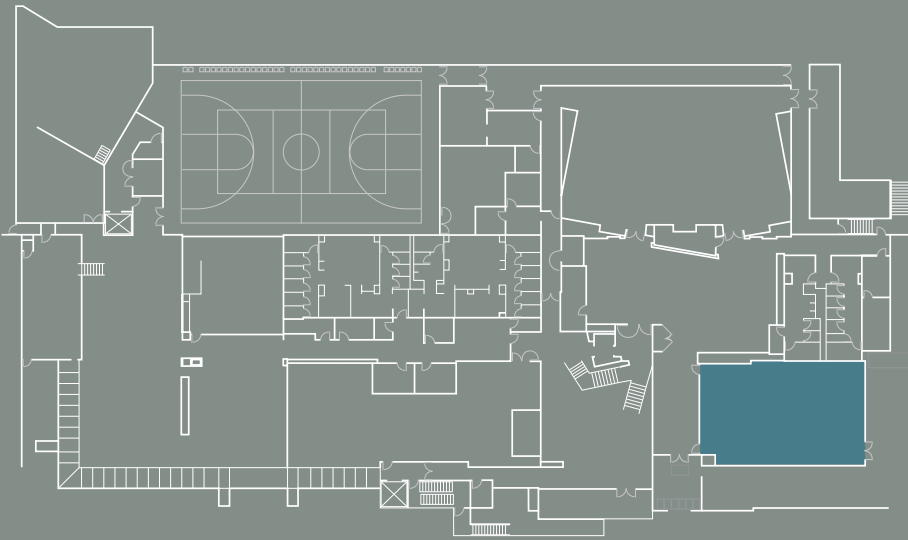

LEVEL ONE

AUDIO / VISUAL CAPABILITY

CONNECTIVITY

- Enterprise level Wi-Fi with up to 100 mbs of bandwidth to support business applications, press events, and WebEx

AUDIO

- Ceiling mounted loudspeakers, usage includes teleconference audio and audio associated with presentations
- Lavalier microphones, podium microphone, wireless handheld microphones and wireless push to talk gooseneck microphones
- Genre based music stations for playing background music

VIDEO

- Two 90" HD LCD displays
- Laptop inputs located at the front and rear of the room for analog video (VGA) with audio and digital video (HDMI)

CONTROL SYSTEM

- One wall mounted iPad based system controller and free-floating iPad controller
- iPads select between the inputs, control volume, and control all room AV features

ENTRANCE



THEATER STYLE - 122 SEATS

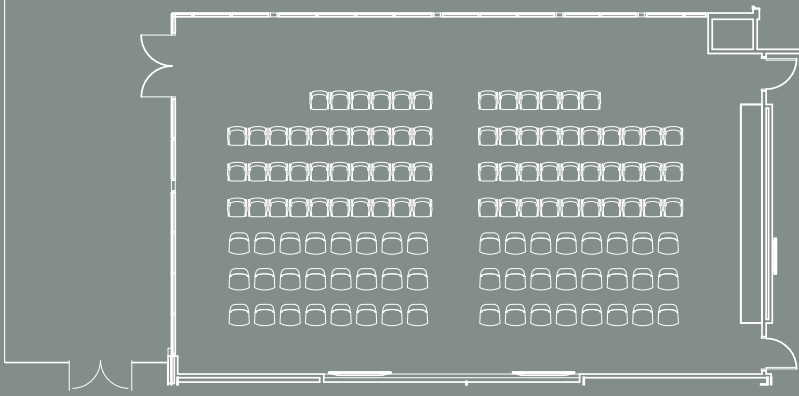

TRAINING STYLE A* - 80 SEATS

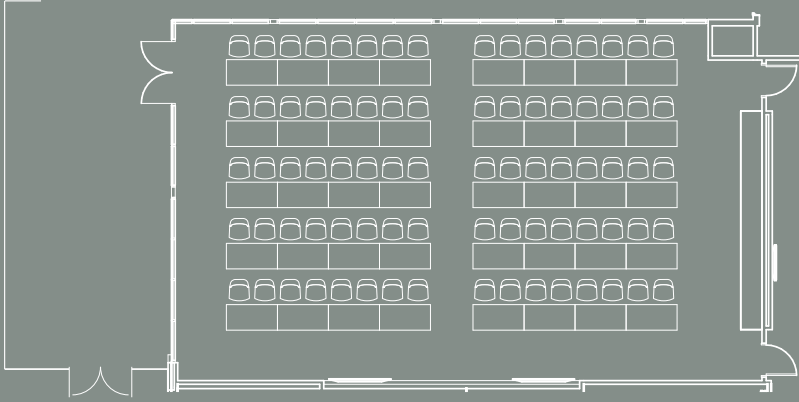

TRAINING STYLE B* - 60 SEATS

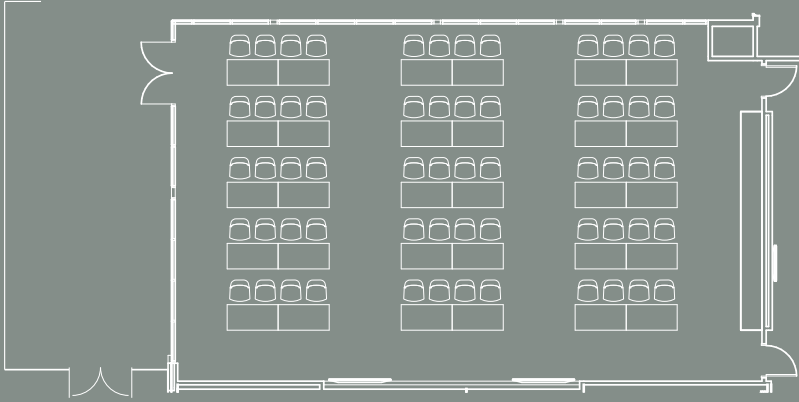

BOARDROOM STYLE* - 54 SEATS

